

PROPERTY LOCATION
 Part of Block 12 and 13, Original Plat of the CITY OF RED WING, on file in the Goodhue County Records Office.

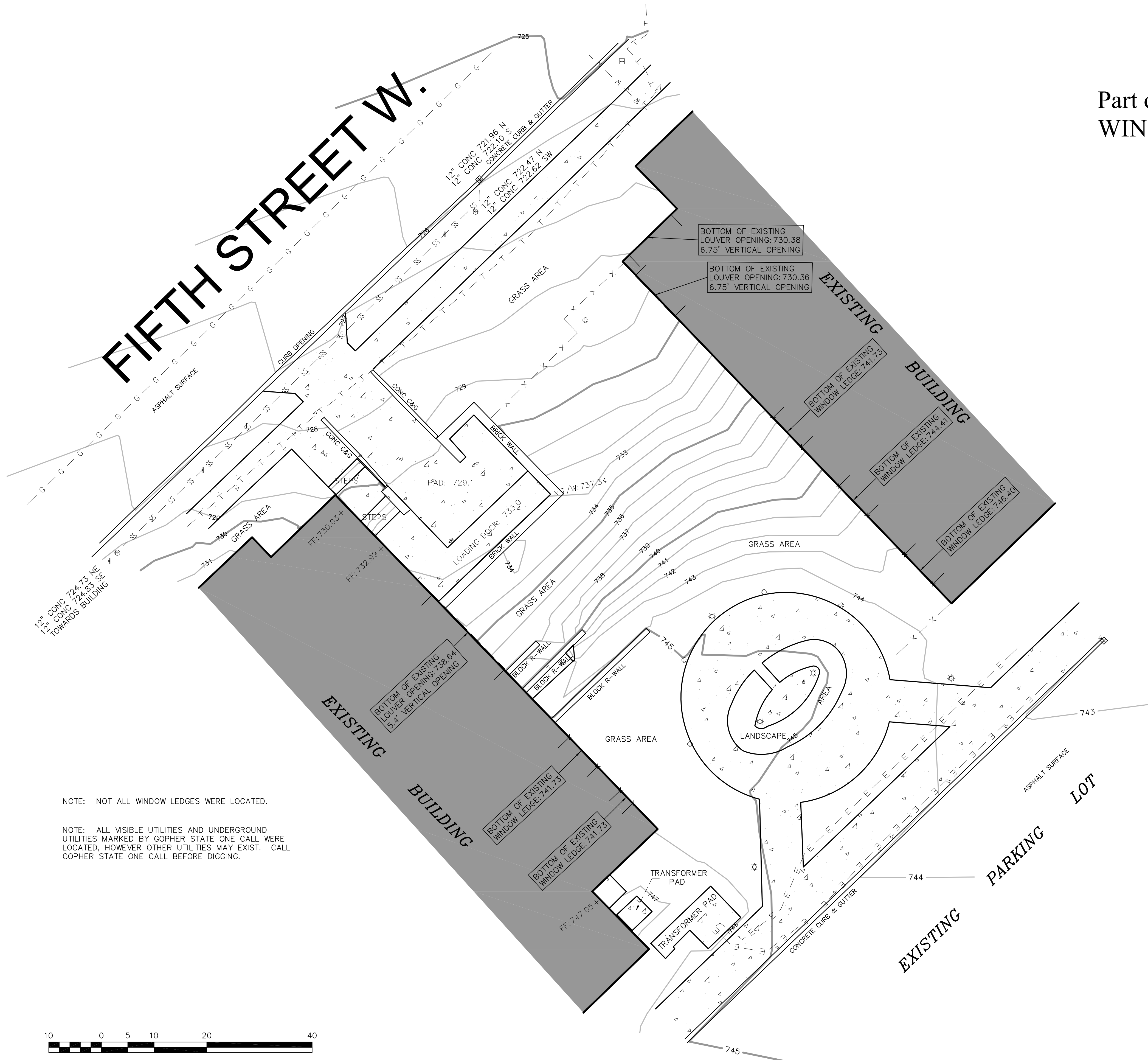

LEGEND

These standard symbols will be found in the drawing.

- X - X - EXISTING SPLIT RAIL FENCE.
- + EXISTING SIGN.
- ⊕ EXISTING MANHOLE.
- ⊞ EXISTING HANDHOLE.
- ⊗ EXISTING WATER VALVE.
- ⊛ EXISTING LIGHT OR LIGHT POLE.
- SS - SS - EXISTING UNDERGROUND STORM SEWER.
- W - W - EXISTING UNDERGROUND WATERMAIN.
- E - E - EXISTING UNDERGROUND ELECTRIC.
- T - T - EXISTING UNDERGROUND TELEPHONE.
- G - G - EXISTING UNDERGROUND GAS.
- ⚓ EXISTING FLAG POLE.
- ⊕ EXISTING DECIDUOUS TREE.
- ⊞ EXISTING STORM WATER CATCH BASIN.
- FF: 730.03 + EXISTING FINISHED FLOOR ELEVATION.
- 730.03 + EXISTING SPOT ELEVATION.
- ◻ ◻ EXISTING CONCRETE SURFACE.

BENCHMARK

MNDOT GPS POINT RW 4 2010. 678.59' NAVD88
 ORIENTED TO THE GOODHUE COUNTY COORDINATE SYSTEM, NAD83, 1996 ADJ., HARN.

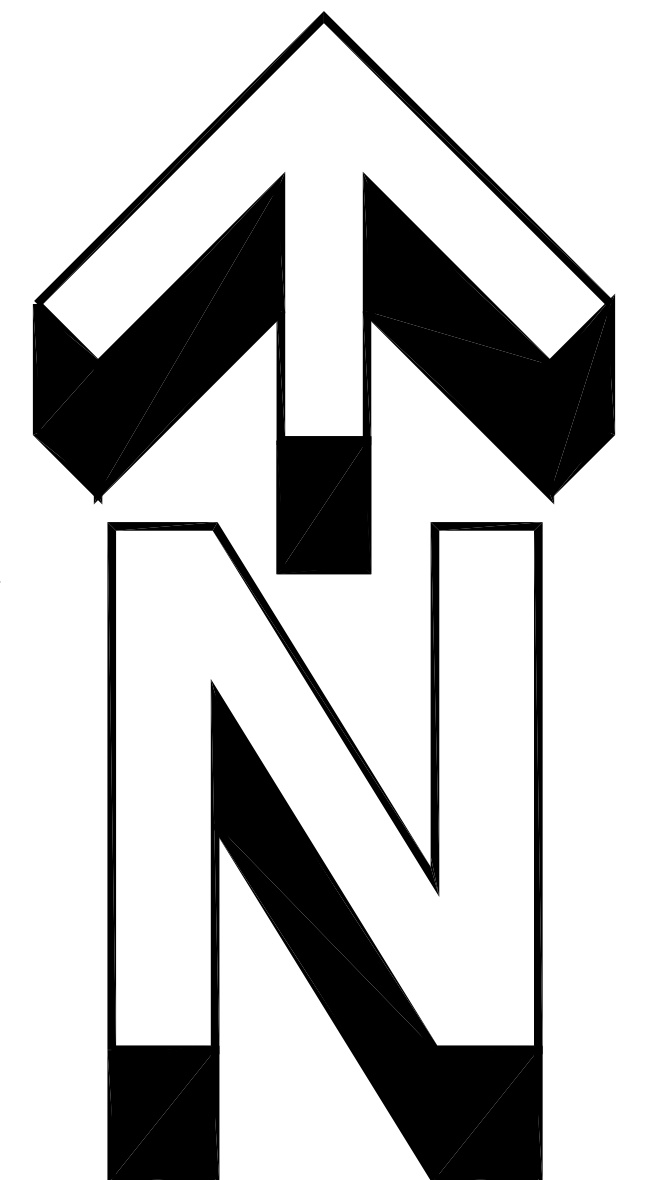

NOTE: NOT ALL WINDOW LEDGES WERE LOCATED.

NOTE: ALL VISIBLE UTILITIES AND UNDERGROUND UTILITIES MARKED BY GOPHER STATE ONE CALL WERE LOCATED, HOWEVER OTHER UTILITIES MAY EXIST. CALL GOPHER STATE ONE CALL BEFORE DIGGING.



TOPOGRAPHIC SURVEY FOR:

JOHNSON & SCOFIELD INC.
 SURVEYING AND ENGINEERING
 1203 MAIN STREET, RED WING, MN 55066
 (651) 388-1558

I hereby certify that this survey, plan or report was prepared by me or under my direct supervision and that I am a duly Licensed Land Surveyor under the laws of the State of Minnesota.

Marcus S. Johnson
 Minnesota License No. 47460
 Date: 7/26/2013

BK. NA	PG. NA	W.O.#	DRAWING NUMBER
SHEET 1 OF 1 SHEETS	13-343	R-2579	